



Automated Minibars

Bartech is credited as a pioneer in the field of minibar technology, having developed the first ever open-display automated minibar over 20 years ago.

Automated minibars allow for a wide variety of distinct advantages

- **Revenue Enhancement.** Separate trays for impulse purchases
- **Security.** Minibars remain locked until the room is allocated to a guest. Re-stocking requires remote control access.
- **Loss Minimisation.** Product and Revenue losses due to disputes or theft are reduced to $\leq 2\%$ of revenue
- **Costs.** Dramatic reduction in staffing/labour costs as one attendant is able to manage up to 300 rooms per day
- **Stock Control.** Statistical reporting on sales ensures efficient stock re-ordering. Ability to further optimise through product expiry date control and stock rotation alarm



C32 ▶ 40 Lt

AUTOMATIC

C32 W



C32 BB



C32 GD



C32 GD



automatic minibars

PRODUCT 32 product positions available with big bottle balcony

DOOR TYPE foam-core door panel optional wooden or glass door

DOOR COLOR black, other colors available on request

DIMENSIONS W: 400mm - 15.75 inches
H: 570mm - 22.44 inches
D: 485mm - 19.09 inches

OPTIONAL integrated dry sections on wooden door models
external sections for dry products



C32

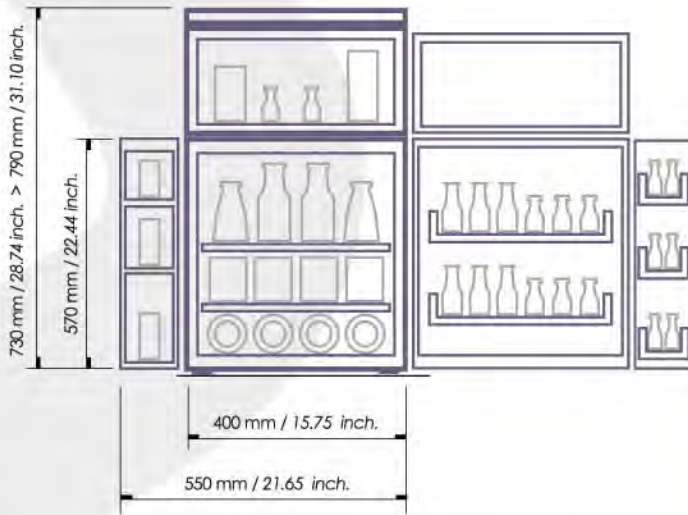

Integrated dry sections available on wooden door versions

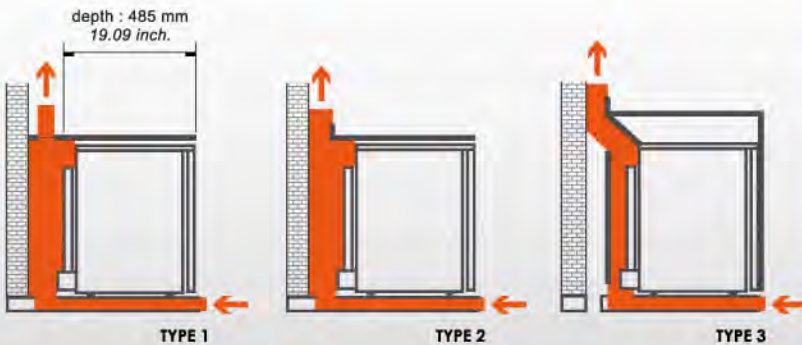

240 cm² / 38 inch² clear area for airflow

The minibar must be properly ventilated. A channel for air circulation under the minibar, passing up over the cooling unit and exhausting out of the minibar cabinet is mandatory.

A 50 mm free space is recommended between the wall or cabinet back and the cooling unit.

STANDARD C32

SHELVES WITH SENSORS 8 small bottles
8 cans
4 laid down bottles

DOOR BALCONIES WITH SENSORS 12 miniatures or snacks

OPERATING SYSTEM Win 2003
Win XP
Vista

SOFTWARE Windows
Web based

INTERFACE TYPES TCP IP / RS 232

DATA COMMUNICATION Ethernet
Twisted pair
ZigBee
Coax cable
Wi-Fi

DATABASE ENGINE SQL
Access

COOLING UNIT Compressor
Absorption

SENSORS Infrared
Microswitches
Magnetic

VOLTAGE 110 - 240 VAC / 50-60 HZ

C41 ▶ 55 Lt

AUTOMATIC

C41



C41 GD



C41 WTD



automatic minibars

PRODUCT 41 product positions
available with big bottle balcony

DOOR TYPE foam-core door panel
optional wooden or glass door

DOOR COLOR black, other colors available
on request

DIMENSIONS W: 450mm - 17.72 inches
H: 570mm - 22.44 inches
D: 485mm - 19.09 inches

OPTIONAL integrated dry sections on wooden
door models
external sections for dry products



C41

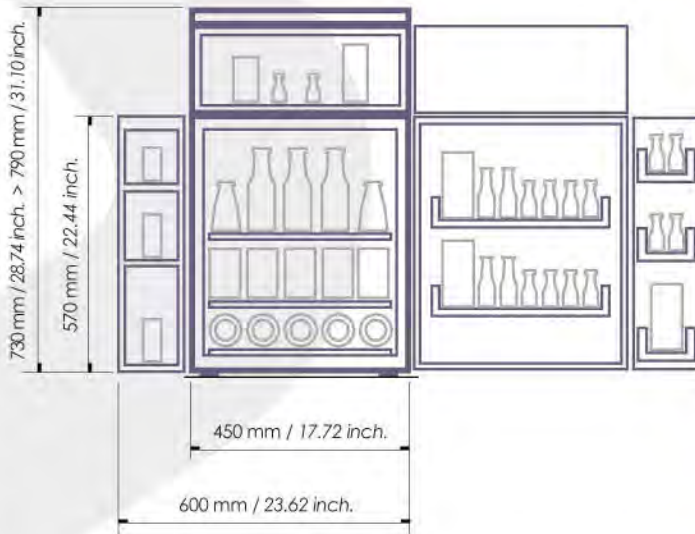

Integrated dry sections available on wooden door versions

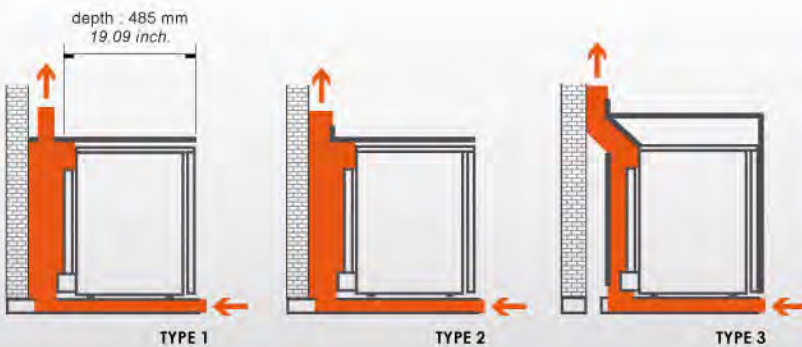

240 cm² / 38 inch² clear area for airflow

The minibar must be properly ventilated. A channel for air circulation under the minibar, passing up over the cooling unit and exhausting out of the minibar cabinet is mandatory.

A 50 mm free space is recommended between the wall or cabinet back and the cooling unit.

STANDARD C41

SHELVES WITH SENSORS 10 small bottles
10 cans
5 laid down bottles

DOOR BALCONIES WITH SENSORS 16 miniatures or snacks

OPERATING SYSTEM Win 2003
Win XP
Vista

SOFTWARE Windows
Web based

INTERFACE TYPES TCP IP / RS 232

DATA COMMUNICATION Ethernet,
Twisted pair,
ZigBee,
Coax cable,
Wi-Fi

DATABASE ENGINE SQL
Access

COOLING UNIT Compressor
Absorption

SENSORS Infrared
Microswitches
Magnetic

VOLTAGE 110 - 240 VAC / 50-60 HZ

automatic minibars

CH41 ▶ 65 Lt

AUTOMATIC

CH41



CH41 W



CH41 with CourtesyX



automatic minibars

CH41



PRODUCT	41 product positions
DOOR TYPE	foam-core door panel optional wooden or glass door
DOOR COLOR	black, other colors available on request
DIMENSIONS	W: 450mm - 17.72 inches H: 650mm - 25.59 inches D: 485mm - 19.09 inches
OPTIONAL	integrated dry sections on wooden door models external sections for dry products

automatic minibars

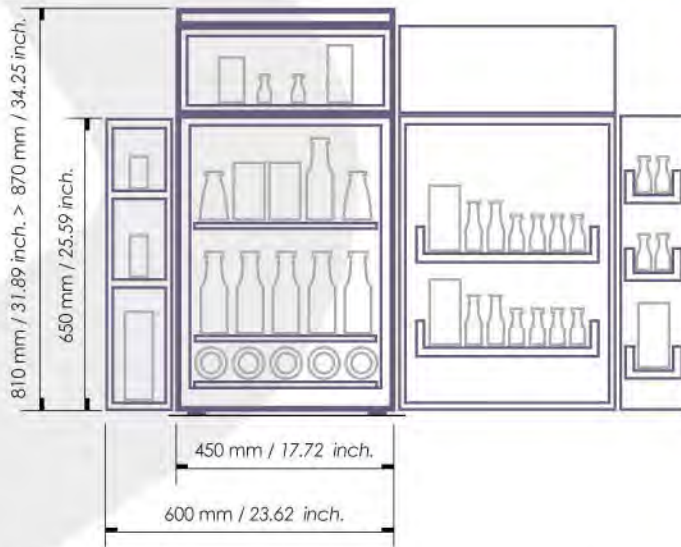

Integrated dry sections available on wooden door versions

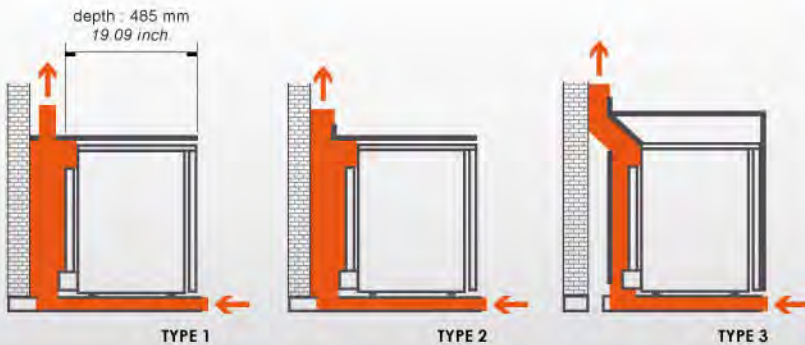

240 cm² / 38 inch² clear area for airflow

The minibar must be properly ventilated. A channel for air circulation under the minibar, passing up over the cooling unit and exhausting out of the minibar cabinet is mandatory.

A 50 mm free space is recommended between the wall or cabinet back and the cooling unit.

STANDARD CH41

SHELVES WITH SENSORS	20 small bottles or cans 5 laid down bottles
DOOR BALCONIES WITH SENSORS	16 miniatures or snacks
OPERATING SYSTEM	Win 2003 Win XP Vista
SOFTWARE	Windows Web based
INTERFACE TYPES	TCP IP / RS 232
DATA COMMUNICATION	Ethernet Twisted pair ZigBee Coax cable Wi-Fi
DATABASE ENGINE	SQL Access
COOLING UNIT	Compressor Absorption
SENSORS	Infrared Microswitches Magnetic
VOLTAGE	110 - 240 VAC / 50-60 HZ

CD46 ▶ 70 Lt

AUTOMATIC

automatic minibars

CD46 W



CD46 WTD



CD46 W



CD46 GD



CD46 W



PRODUCT 23 product positions
additional 25 litre refrigerated
section for guest personal use

DOOR TYPE wooden door
optional glass door

DOOR COLOR black, other colors available
on request

DIMENSIONS W: 520mm - 20.47 inches
H: 570mm - 22.44 inches
D: 485mm - 19.09 inches

OPTIONAL optional integrated top dry sections
external sections for dry products

automatic minibars

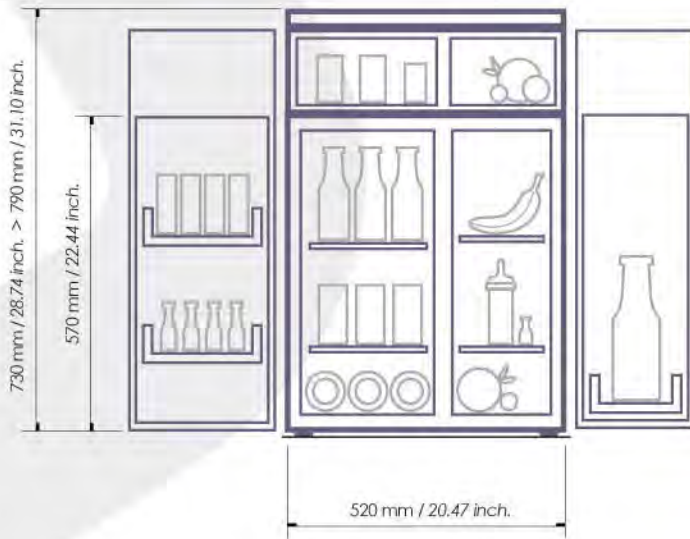

Integrated dry sections available on wooden door versions

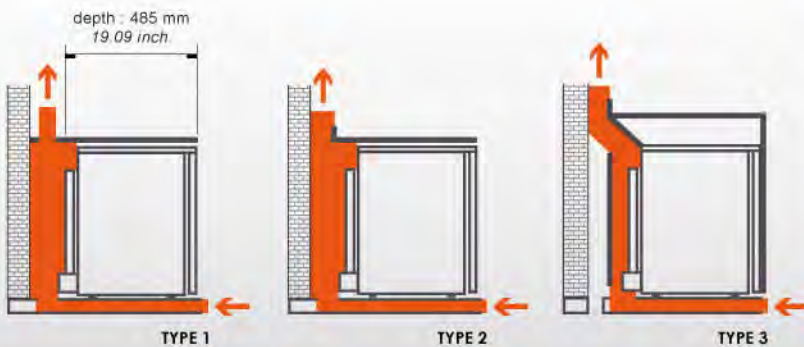

240 cm² / 38 inch² clear area for airflow

The minibar must be properly ventilated. A channel for air circulation under the minibar, passing up over the cooling unit and exhausting out of the minibar cabinet is mandatory.

A 50 mm free space is recommended between the wall or cabinet back and the cooling unit.

STANDARD CD46

SHELVES WITH SENSORS 6 small bottles
6 cans
3 laid down bottles

DOOR BALCONIES WITH SENSORS 8 miniatures or snacks

OPERATING SYSTEM Win 2003
Win XP
Vista

SOFTWARE Windows
Web based

INTERFACE TYPES TCP IP / RS 232

DATA COMMUNICATION Ethernet
Twisted pair
ZigBee
Coax cable
Wi-Fi

DATABASE ENGINE SQL
Access

COOLING UNIT Compressor
Absorption

SENSORS Infrared
Microswitches
Magnetic

VOLTAGE 110 - 240 VAC / 50-60 HZ

A white wireframe globe icon is positioned on the left side of a blue horizontal banner.

RELIABILITY IS THE KEY

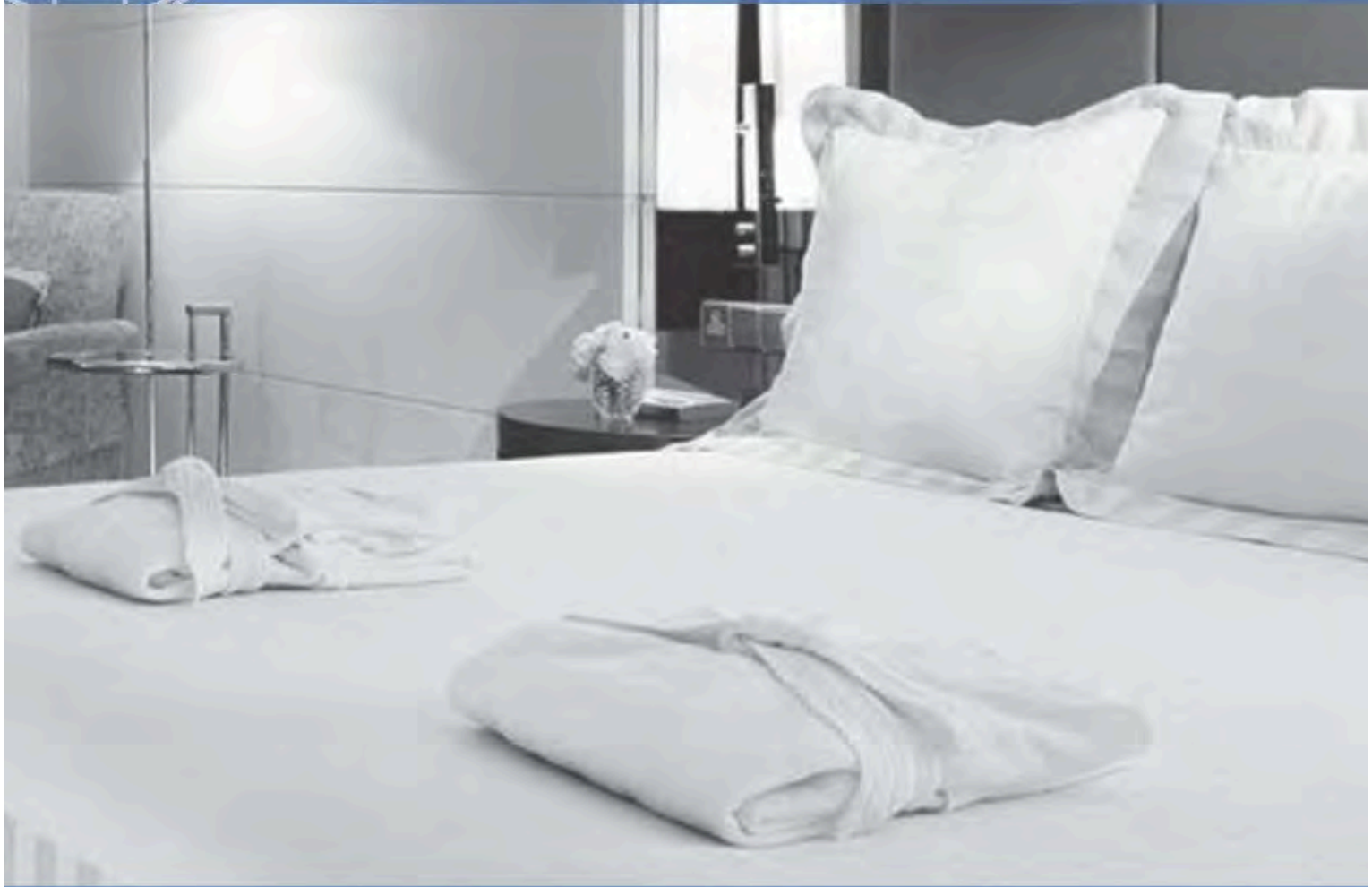

For more information about this product or to talk to one of our sales specialists please contact us.

Vintech Systems

Phone: +61 2 9472 2000

Email: info@vintech.com.au